

SM4 GRAVITY WATER FILTER

ASSEMBLY AND OPERATING INSTRUCTIONS



Thank you for purchasing one of our ENVIROGARD / Rainfresh Water Filters.
We are committed to ensuring that you are **totally satisfied**.

For any questions, please contact customer service

CUSTOMER SERVICE	001 (905) 884 9388. Canada Toll Free 1800 667 8072 (Mon to Fri 8:30 AM to 5:00 PM EST) E-Mail : info@rainfresh.ca ; Web : www.rainfresh.ca
-------------------------	---

CONTENTS

- A. Introduction2
- B. Notes & Warnings.....2
- C. Assembly2
- D. Operation.....4
- E. Cartridge Cleaning.....4
- F. Cartridge Life4
- G. Warranty.....4



Tested and Certified by CSA International to NSF/ANSI Standard 53 for reduction of Cyst (e.g. Cryptosporidium & Giardia).
The standard referenced above evaluates products for use with disinfected waters.

Additional testing and verification for reduction of bacteria and particulates performed by independent laboratory.

(A) INTRODUCTION

This SM4 Gravity water filter unit is designed to trap and kill harmful bacteria >99.99999% (E. coli, Coliform, Faecal Coliform), trap > 99.95% protozoan cysts (e.g. Giardia, Cryptosporidium) and filter particulates as small as 0.3 micron (99.9%). It also reduces chlorine, taste and odour, giving safe, fresh, clean & great tasting water. It can be used on well, lake, pond, river, cistern or even municipally treated water.

It contains four self-disinfecting silver impregnated ceramic cartridges (7500G) which are cleanable and reusable.





(B) NOTES & WARNINGS:

1. Contaminants reduced by this filter are not necessarily in your water. Individuals requiring water of specific microbiological purity should follow the advice of their doctor or local health unit.
2. For cold water use only
3. Do not subject this unit to freezing temperatures or it will crack.
4. Do not boil the cartridges to disinfect. They are self-disinfecting.

(C) ASSEMBLY

NOTE: Ceramic cartridges are fragile, please handle carefully.

The following items are included with the SM4 system

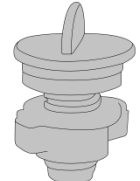
Item	Steel container set with base	Spigot	Ceramic Filters	Scrubbing Pad	Filter Gauge	Hole Plug
Part #	856	854	7500G	811-0	703-4	859
Quantity	1	1	4	1	1	2
			 FRAGILE			

Unpack the unit. Separate the 2 steel containers. 4 ceramic cartridges, spigot, cleaning pad & gauge are shipped inside the containers. Remove contents and lay aside.



Slide one gasket on to the spigot with flat side facing spigot

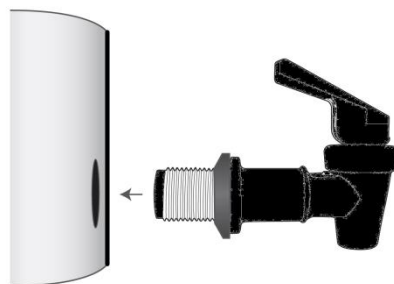

Insert the threaded end of the spigot in to the spigot hole in the bottom steel container

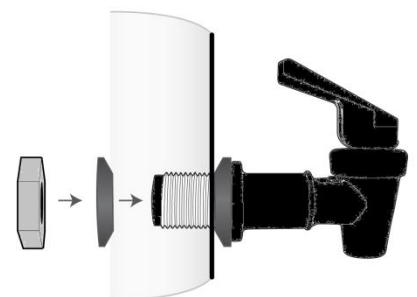

Attach the second gasket from inside (flat end facing away from spigot) and thread in the nut



Firmly hand-tighten the nut from inside the bottom container. Place the bottom container now on rubber base.



Remove wing nut from one cartridge and slide on the rubber gasket on to the ceramic cartridge nozzle



Insert cartridge through the hole with nozzle protruding through the bottom. **Make sure that the rubber gasket is on the inside of the container.** Repeat for all cartridges



Secure the cartridge by hand-tightening the wing nut from the outside. **Do not over-tighten.** Repeat for other 3 ceramic cartridges.

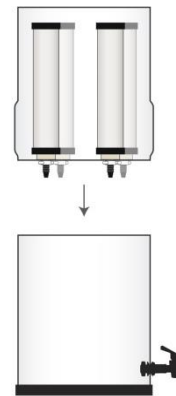
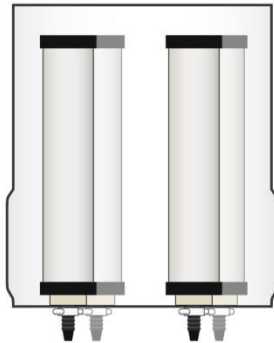

Place the top container with the ceramic cartridges on the bottom container

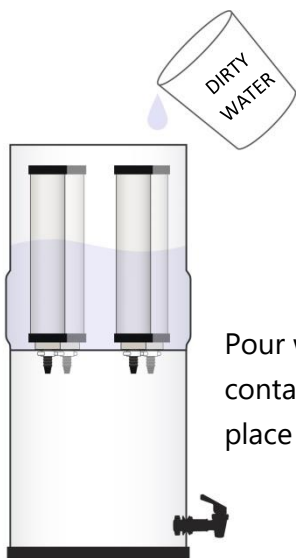

Pour water into the top container until it is full and place lid on top

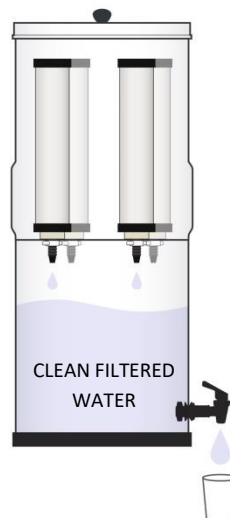

After several hours (overnight) the water will filter through the ceramic cartridges and filtered water will collect in the bottom container. Discard the filtered water and re-fill top container twice. **Your unit is now in service**

CAUTION : Do not pour more water in the top bucket than can collect in the bottom bucket or overflow will occur.

(D) OPERATION

1. The containers hold about 8.5 litres of water (2.2 U.S. Gallons). The flow rate of the unit is up to 3 L/hr with a full top bucket but this rate will decline as it empties. You should allow about **3-4 hours** for the top bucket to fully empty into the bottom bucket.

(E) CARTRIDGE CLEANING

Note: Do not use soap or detergents when cleaning. Use only water.

When the water is taking much longer to flow from top to bottom, the cartridges require cleaning. Use cleaning pad provided for best results. Cartridge may be cleaned many times until cartridge gauge 703-4 can be passed over width of the ceramic. When 703-4 can be passed over the width of the ceramic it is time to replace the cartridge.

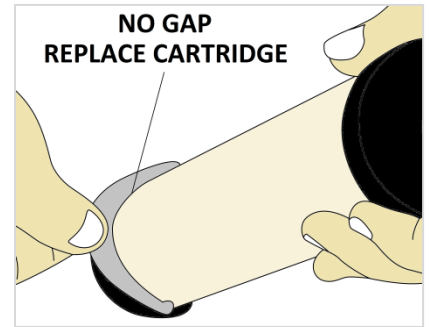
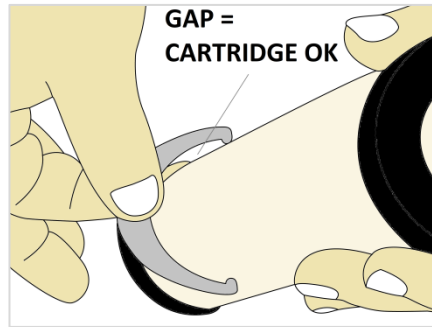

The use of rubber gloves (i.e. dishwashing gloves) or other sensible hygiene precautions is recommended during handling, cleaning or disposal of the dirty cartridge.

1. To remove the cartridges for cleaning, disassemble by unscrewing the wing nut and removing both wing nut and gasket. Take cartridge into the palm of your hand and scrub the surface evenly under running water using the cleaning pad supplied, until all discolouration is removed and the original ceramic colour returns. Take care not to contaminate the threaded nozzle area.
2. Replace cartridges into holes (gasket on the inside of bucket) and hand tighten wing nut under the lid.

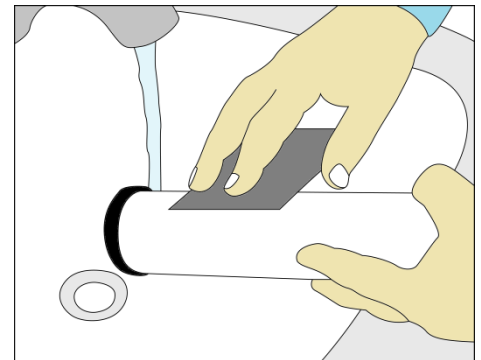

Caution:

1. Only open the lower bucket when necessary as this could allow airborne bacteria to re-infect the water.
2. Do not store filtered water in uncovered containers.
3. Do not install a broken filter cartridge. Broken filter cartridges should be discarded and replaced with a new cartridge. **If a new cartridge is not immediately available, the hole in the top bucket should be plugged with the hole-plug (859) included with the unit.**

(F) CARTRIDGE LIFE

(Approximate): 6 months to 12 Months. Cartridge life is directly related to your water conditions, volume of water filtered and frequency of cleaning. Frequent cleaning ensures best efficiency. The SM4 can be kept in a cooler/refrigerator etc. while in operation.

(G) LIMITED FIVE (5) YEAR WARRANTY

SM4 system is warranted, to the original purchaser/owner, for a period of **five (5) years**, from the date of purchase, against defects in materials or workmanship. Envirogard's obligation under this warranty shall consist of repair, replacement or credit, at its option, of any part found by company inspection to be defective, provided that the product has not been misused, abused, altered or damaged as determined by the company and provided that only approved Envirogard replacement cartridges have been used in the housings. Ceramic cartridges require regular replacement and are warranted for manufacturing defects only. Used cartridges are not warranted.



ENVIROGARD PRODUCTS LIMITED

446 Major Mackenzie Dr. E. Richmond Hill, ON Canada L4C 1J2

Tel: 001 905 884 9388 ; **Fax:** 001 905 884 3532

E-Mail: info@rainfresh.ca **Web:** www.rainfresh.ca